

Approved Waipa District Council
Building Department
40305
Subject to conditions of
Building Consent No.

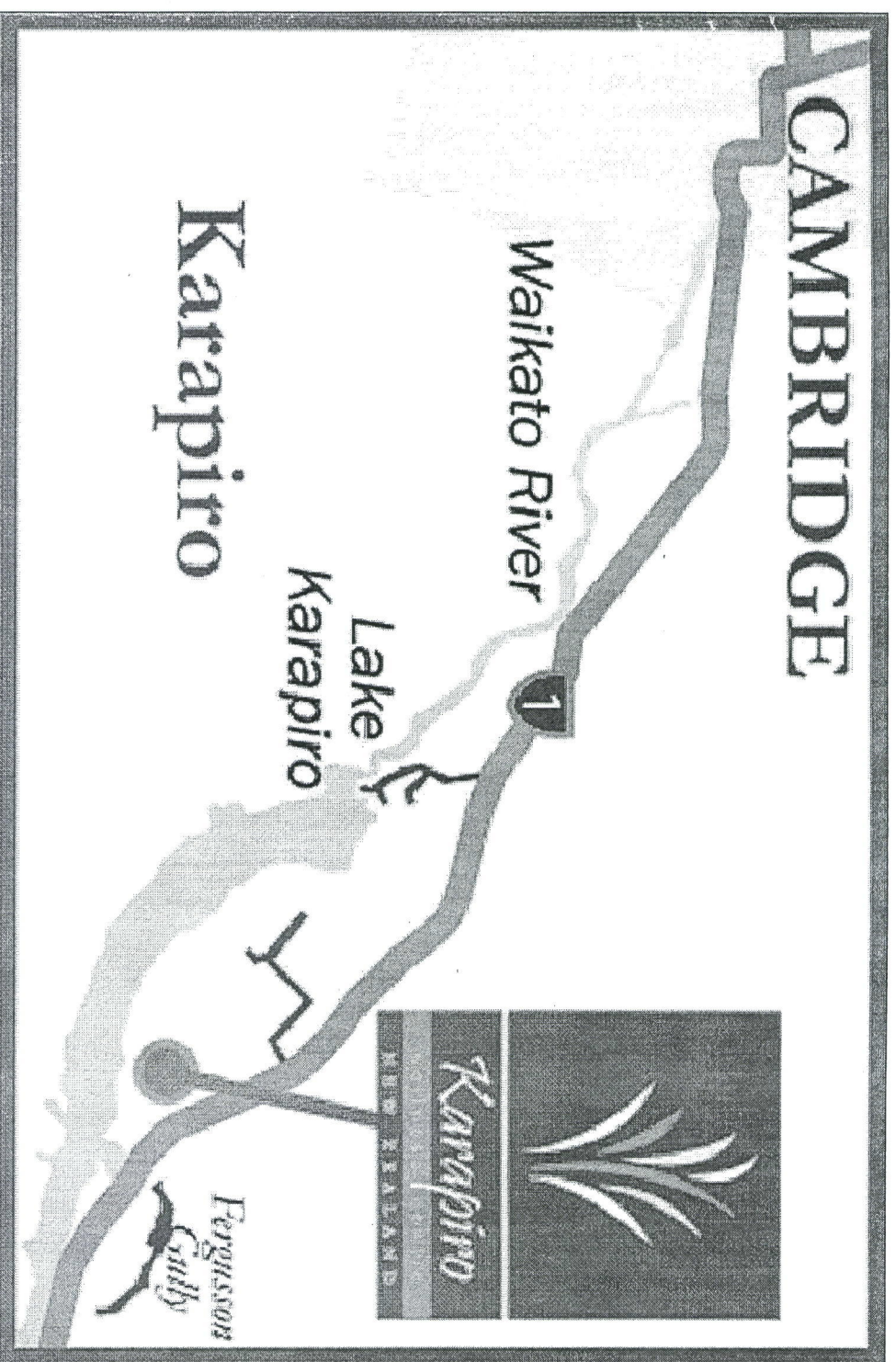

KARAPIRO HEALTH SPA

1002, Highway 1, Karapiro (Chalet B)

Units 1-33

ARCHITECTURAL DRAWING

- A301a - Ground Floor Plan (Chalet Type B)
- A301b - Comparison for Original and latest floor plan (Chalet Type B)
- A302 - Elevations(Chalet Type B)
- A303 - Sections(Chalet Type B)
- A304 - Details(Chalet Type B)
- A305 - Bracing and Roof Framing Plan(Chalet Type B)
- A306 - Electrical Plan(Chalet Type B)
- A307 - Door and Window Schedules (Chalet Type B)

FOR CONSTRUCTION - 06 / 7 / 2007

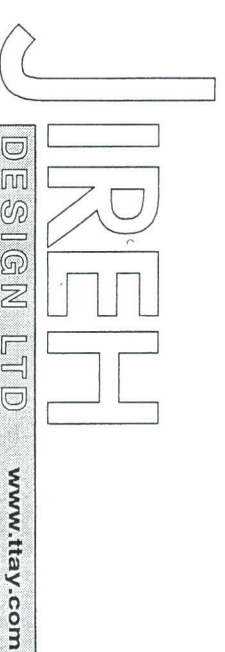

TONY TAY GROUP
LEVEL 1, 540 GT SOUTH ROAD, GREEN LANE, PO BOX 68220 NEWTON
AUCKLAND, NZ PHONE: +64 9 580 1750 FAX: +64 9 580 3180

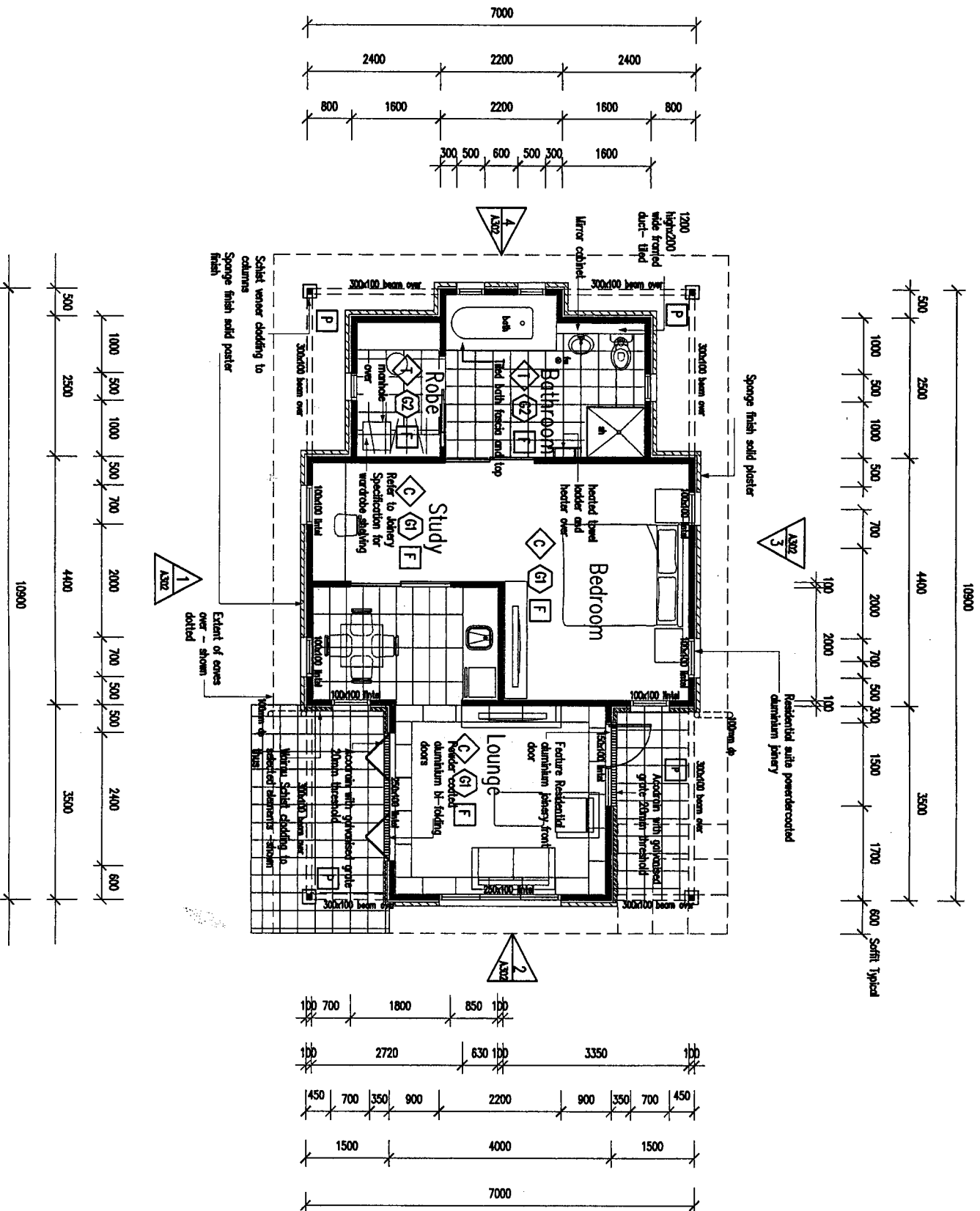

LEGEND

- Floor Finishes**
 - T** Selected Tile finish.
 - C** Selected Carpet finish on approved underlayment.
- Ceiling Finishes**
 - F** All flat ceiling linings 10mm Gb ultralite to ex 75x40 battens @ 400 c/s. Paint finish.
 - P** 7mm stained treated plygroove soffit lining to bottoms @ 600 c/s.
- Wall Finishes**
 - G1** 10mm Gb board wall lining to timber studs @ 600 c/s paint finish.
 - G2** 10mm Gb 'Aquadine' wall lining. Full height wall tiles.

Interior trims/ Finishes

Window reveals / Doors jambs:
ex 40mm paint finish treated pine jambs, with 60x12mm bullnose architraves.
Skirting:
ex 90x12mm paint finish bullnose skirtings throughout.
Door:
2100 high 'plyco designer v-groove' or equal solid core door, paint quality.

Note:

All ceilings spaces to be insulated with Batt insulation to meet relevant New Zealand Standards - Refer specification.

All contractors to check dimensions on site prior to commencing any work.

Polymer-modified cement-based plaster or polymer-based polystyrene-based plaster Exterior Insulation and Finish Systems (EIFS)

Architectural Floor Plan

Total Area: 59sq.m.

Job

KARAPIRO HEALTH SPA SINGLE CHALET

Client

TONY TAY GROUP

Drawing Title

CHALET TYPE B Ground Floor Plan

Scales

1:50@A1 1:100@A3

Job No.

Drawing No.

Drawn

Checked

Issue Date

Status

Revision

DESIGN LTD

TONY TAY GROUP BUILDING LIMITED, 1400 OF SOUTH ROAD, GREENVALE, PO BOX 4020, HICKTON, AUCKLAND, NZ. PHONE: +64 9 580 1790 FAX: +64 9 580 2180

TONY TAY GROUP

CONSTRUCTION

06/7/2007

A

