

LAKESIDE DEVELOPMENT

LAKESIDE, TE KAUWHATA

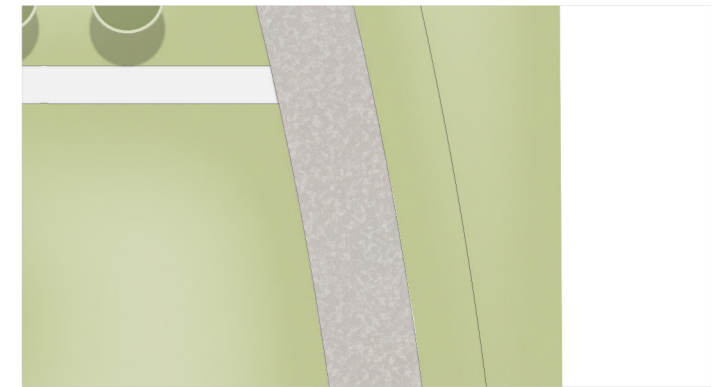
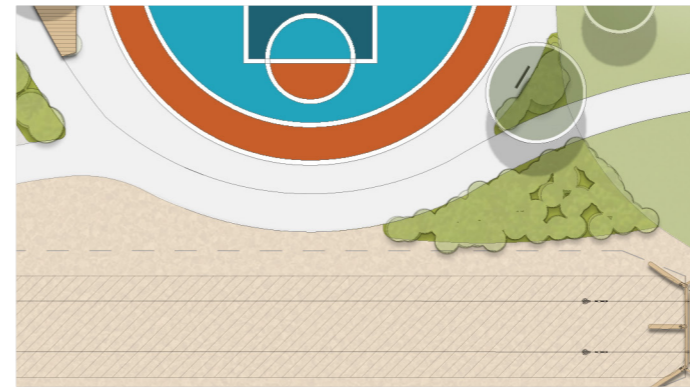
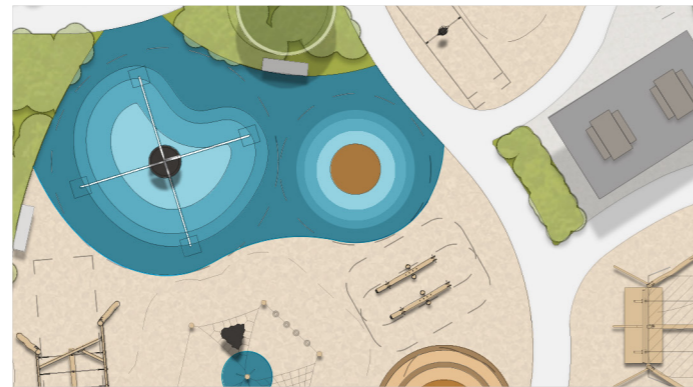

PLAYSPACE 01- COMMUNITY ENGAGEMENT CONCEPT DESIGN

FEBRUARY 2023

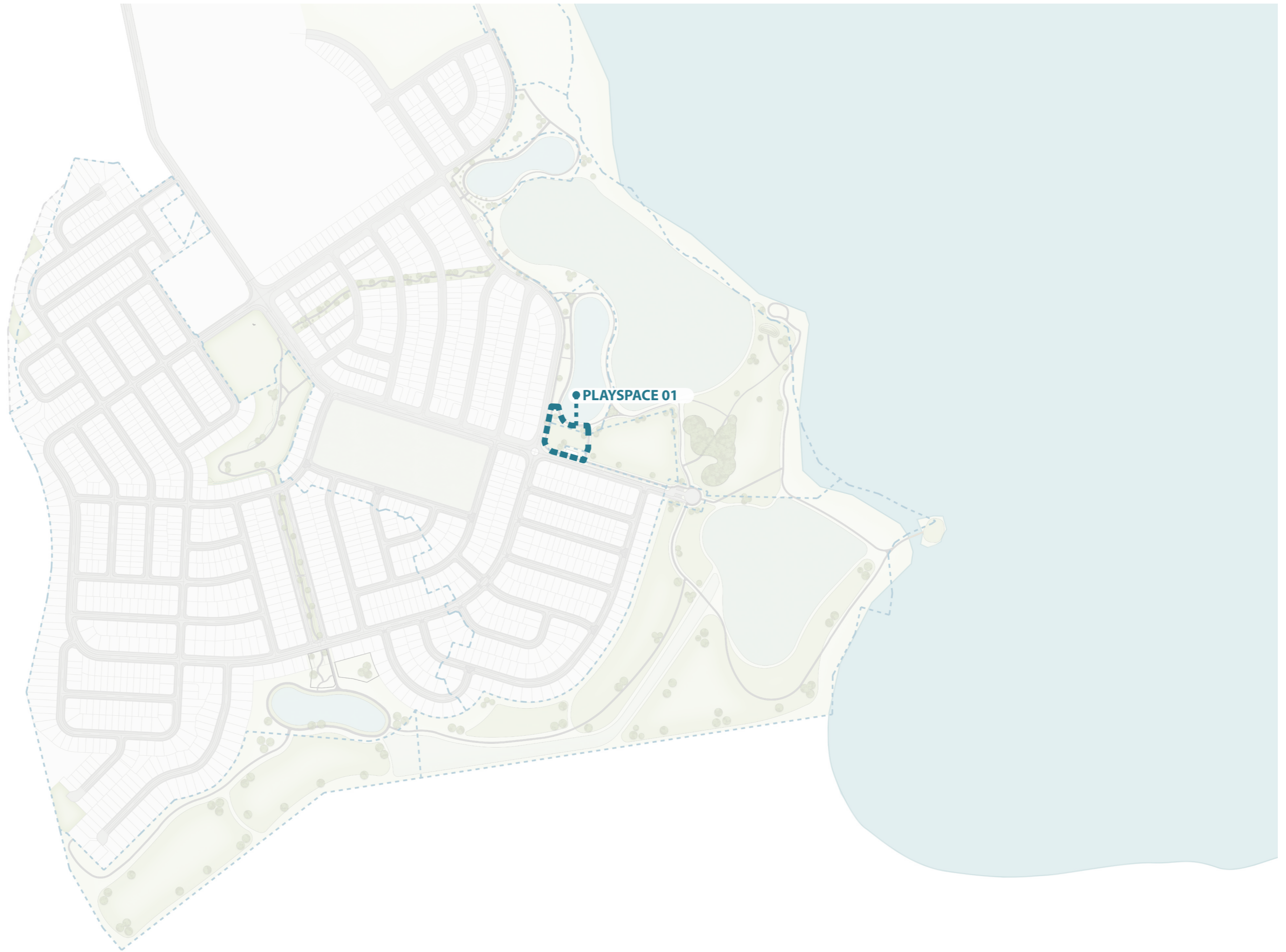



- KEY**
- ★ Social Hub
 - ★ Youth Play
 - ★ Toddler Zone
 - ★ All Age Play
 - ★ Sacred location



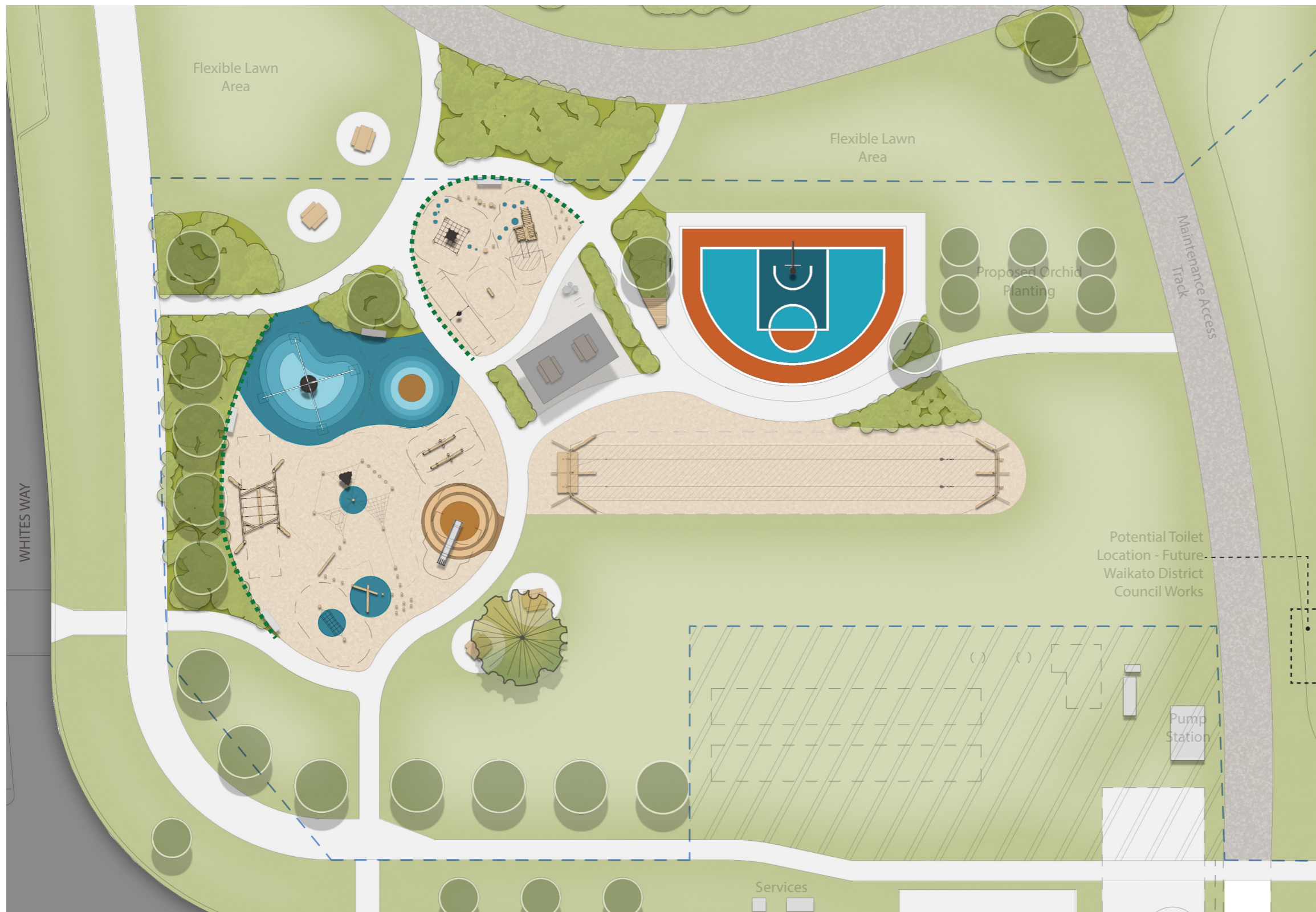

- KEY**
- Concrete Footpath
 - Exposed Aggregate Pavement
 - Loose Aggregate Pathway
 - Bark Softfall Surfacing
 - Rubber Wetpour Surfacing
 - Planting
 - Lawn
 - Tree planting
 - Fencing
 - Lot Boundary





KEY

- Concrete Footpath
- Exposed Aggregate Pavement
- Bark Softfall Surfacing
- Rubber Wetpour Surfacing
- Planting
- Lawn
- Tree planting
- Fencing

- 01. Picnic Tables
- 02. Bench Seating
- 03. Bin Location
- 04. Drinking Fountain & Bike Rack Location
- 05. Basketball Court with colour surfacing
- 06. Inclusive Carousel
- 07. Eagle Claw Basket Swing
- 08. Cocowave Rope Swing
- 09. Kaebel Leisure Net Climb
- 10. Timber Stepping Slits
- 11. Double Timber Seasaw
- 12. Vortex tunnel Net
- 13. Quadtramp
- 14. One Seat Swing Timber
- 15. Toddler Tree Castle
- 16. Toddler Rocker
- 17. Embankment Slide on Wetpour Mound
- 18. Double Flying Fox
- 19. Stepping and Balance logs
- 20. Pohutukawa tree
- 21. Shelter Structure
- 22. Raised Steel Rail Seat
- 23. Timber Platform

Age Range Standard Activities



Specialised Activities





Inclusive Carousel



Single Bucket Swing

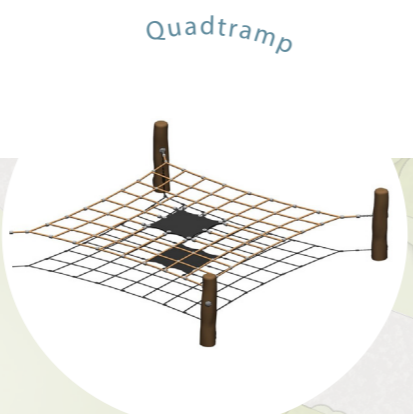

Quadtramp



Log Rocker



Toddler Playhouse



Eagle Claw Basket Swing



Climbing/Balancing Net



Rope Swing



Basketball Court



Double Flying Fox



Vortex Net



1.5m Embankment Slide



Double Sea Saw